

RELEASEAF



Rockworth

Where Nature Creates a Calmer Workspace

RELEAF is a collection designed to bring nature back into the modern workplace. Its modular, free-form configurations allow effortless placement in any environment, creating a balanced link between work and well-being.

Aligned with the principles of Biophilic Design, **RELEAF** helps reduce stress, enhance focus, and support smoother workflow throughout the day. It also features a convenient self-watering system that maintains optimal moisture for plants, making care simple and reliable while keeping workspaces fresh and inviting.

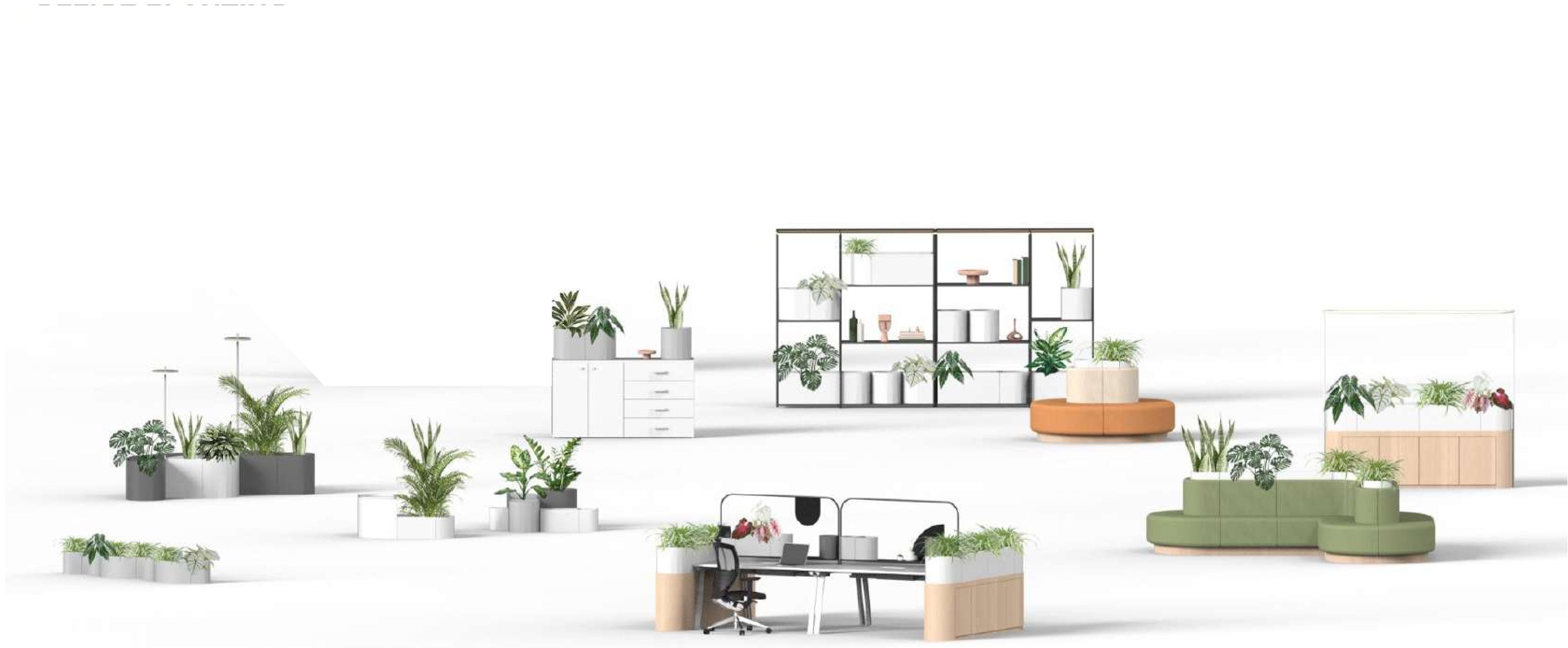



Biophilic solutions for modern offices

Releaf brings nature back into the workplace through thoughtfully crafted planter pots. These planters help purify the air, reduce stress, and create a calmer, healthier atmosphere. With a clean, modern design that fits any office style, they enhance well-being, enrich the workspace with both function and beauty, and add a refreshing natural touch to everyday workspaces.

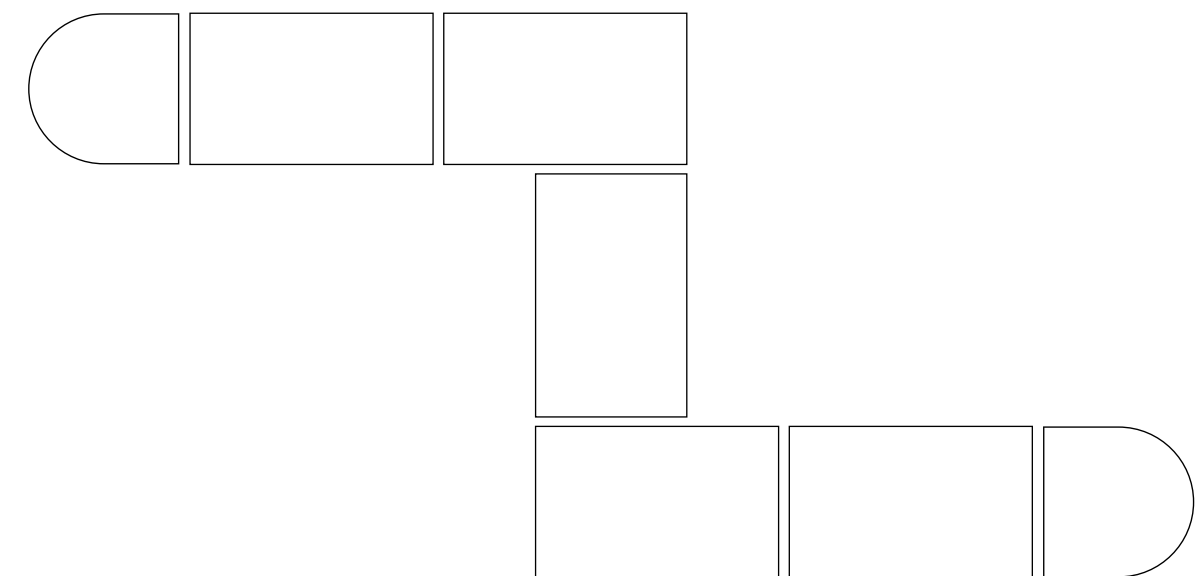
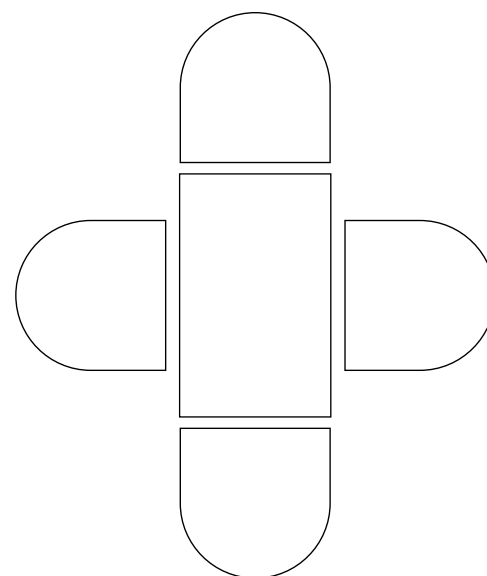
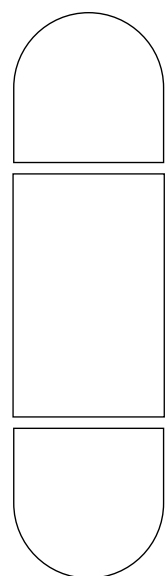

MODULAR PATTERN

Self-Watering System

Releaf is equipped with a self-watering system that uses an absorbent cotton wick to deliver consistent moisture to the plant. Water is stored in a lower reservoir (Part 01), while the perforated plate and cotton rope (Part 02) draw moisture upward through capillary action.

This system ensures the plant receives only the water it needs, and the material's low water absorption helps prevent swelling, warping and structural changes, reducing maintenance and supporting long-lasting healthy growth.

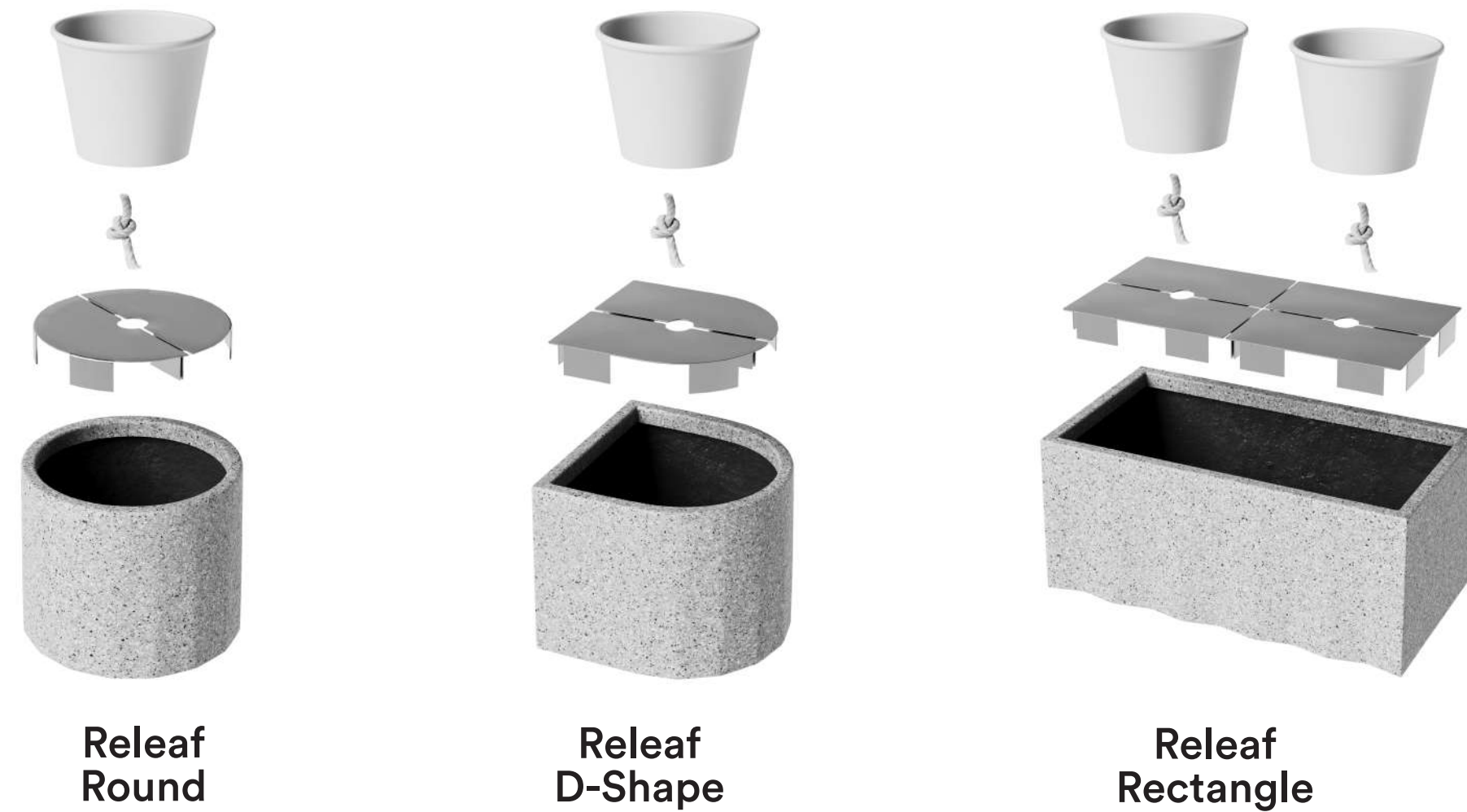

Compatible with 11-inch plant pots only (planter pot not included)



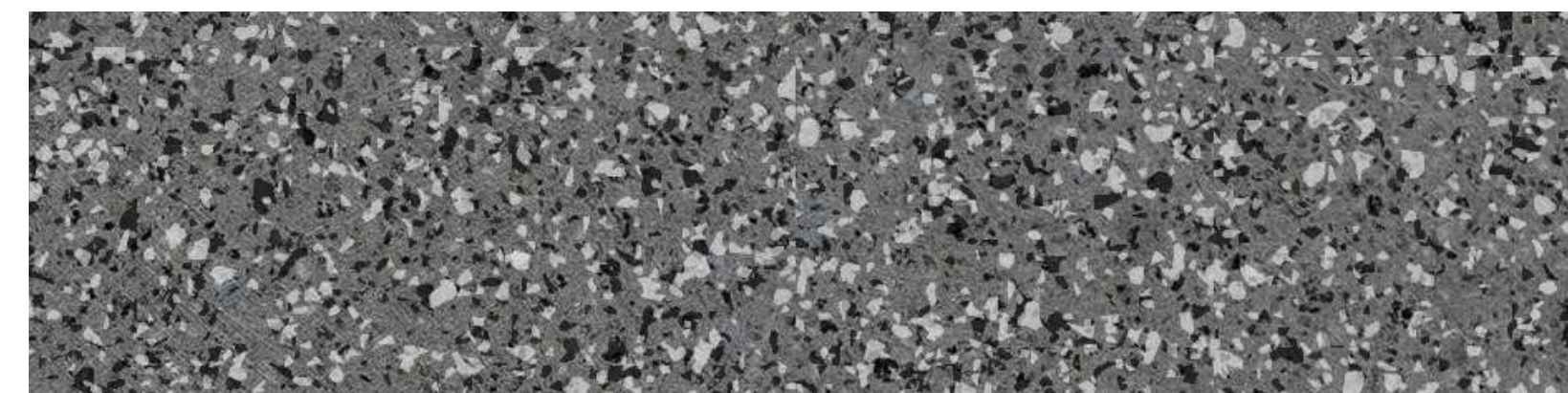
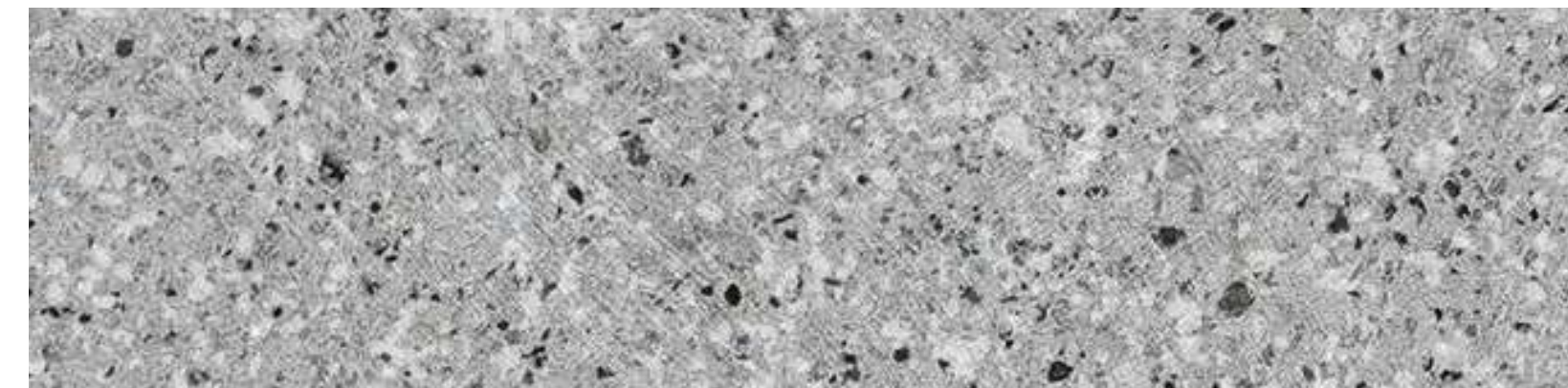

Sustainability

Releaf is made from 30% post-consumer recycled polyethylene and is certified under the Global Recycled Standard (GRS). This high-quality recycled material provides stable color and consistent performance.

With strong, impact-resistant properties and UV protection that helps prevent cracking and fading, Releaf is suitable for both indoor and outdoor use. These products turn waste into durable, long-lasting solutions — reducing environmental impact and supporting a more sustainable future.

STATEMENT OF LINE



RELEAF
Round

RELEAF
D-Shape

RELEAF
Rectangle

Maximum load capacity: 35 kg
Net weight: 2.9 kg

MEASUREMENT

Item	Description	Dimension (mm)		
		H	D	W
Round	Releaf	300	370	370
D-Shape	Releaf	300	370	370
Rectangle	Releaf	300	370	690

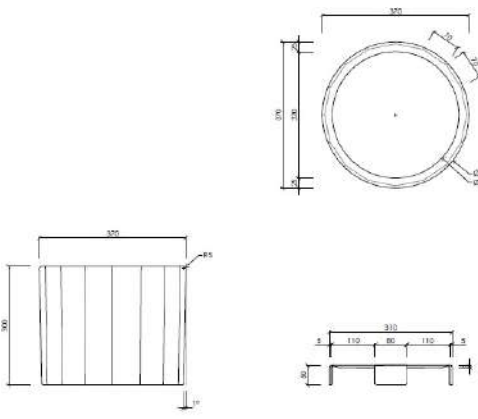

RELEAF
Round

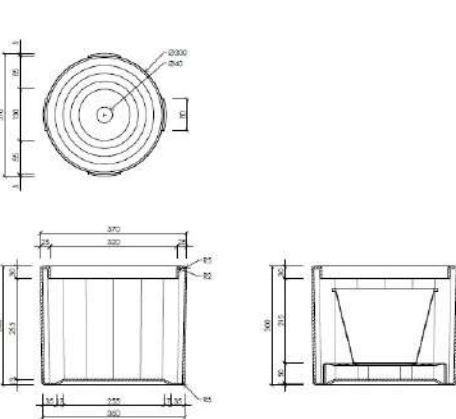

RELEAF
D-Shape

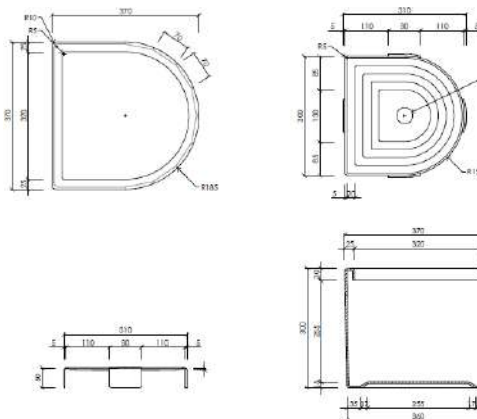

RELEAF
Rectangle

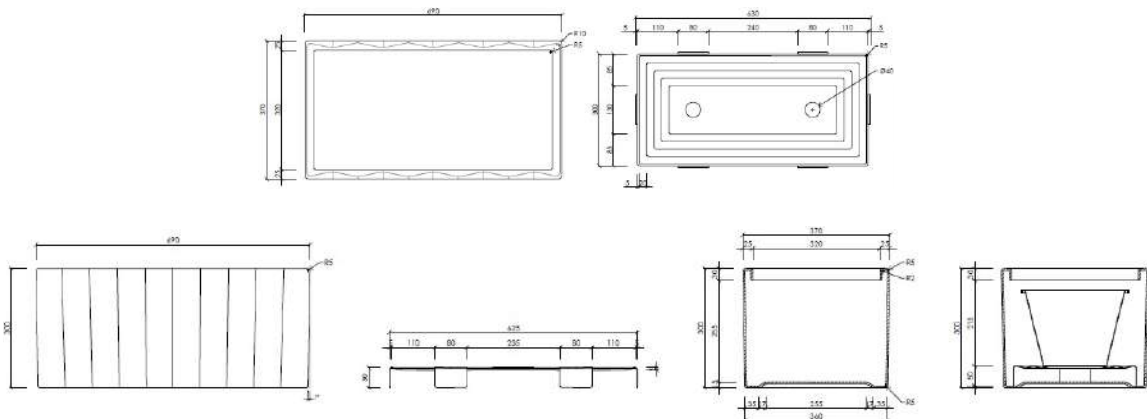

MATERIAL

Body
Made from post-consumer recycled polyethylene plastic, manufactured using the rotational molding process.

Post base
Stainless steel sheet with a thickness of 1.2 mm.

Wick
Cotton wick, 5 mm in diameter.

Remark :
Compatible with 11-inch plant pots only (planter pot not included)

COLOR

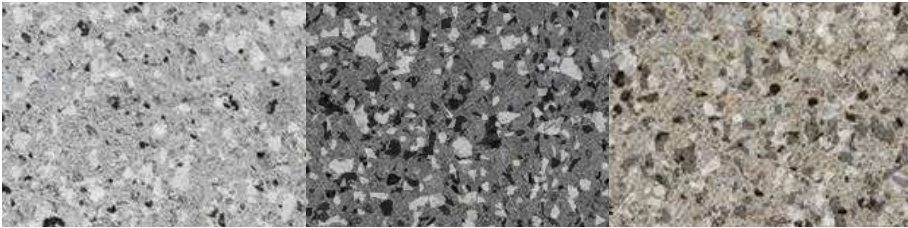

White Marble

Gray Granite

Sand Dune

WARRANTY

5 YEARS

PRODUCT SPECIFICATION



SUSTAINABILITY

Rockworth is committed to operating with integrity and responsibility in everything we do. Our value chain reflects our deep dedication to people and the planet, guiding our actions every day. Sustainability is not just a goal—it is embedded in our mindset, shaping the way we design, produce, and deliver solutions that create a positive impact on businesses, communities, and the environment.

Safe materials

The materials and raw components used in our production processes meet stringent quality standards. They are certified to ensure they pose no risk to human health or the environment.

Waste reduction

We actively minimize raw material waste throughout the design and production stages. Examples include precision computer-cut fabrics and leathers, as well as sourcing materials in clearly defined dimensions to optimize resource usage.

Energy Efficiency

Reducing electricity consumption is a key priority for our company. We implement technical and organizational improvements and provide continuous training for employees to achieve this goal.

Waste segregation

For many years, we have successfully operated a structured waste segregation program, transferring sorted waste to authorized recycling partners. We actively encourage and educate our employees and the local community on effective waste segregation practices.

Environmental protection

We proactively identify and monitor potential environmental risks across all our operations. Our teams remain vigilant, prepared to respond effectively and responsibly whenever environmental threats arise.

CERTIFICATE

ISO 14002: 2015

Gives the requirements for environmental management systems, confirms its global relevance for organizations wishing to operate in an environmentally sustainable manner.

ISO 45001: 2018

Employees’ health and safety in the workplace and improving the well-being of within the workplace environment.

ISO 9001: 2015

Quality Management Systems is a globally recognized standard for quality management. It helps organizations of all sizes and sectors to improve their performance.

ISO 50001: 2018

Energy management system: Makes it easier for organizations to integrate energy management into their overall efforts to improve quality and environmental management.

Scs Indoor Air Quality

Certify to the most transparent Indoor Air Quality (IAQ) standard for furniture and building materials with Indoor Advantage and Indoor Advantage Gold.

Leadership In Energy And Environment

Based on accepted energy and environmental principles and strikes a balance between known establishedpractices and emerging concepts.

Indian Building Council Member

USGBC is best known for its development of the Leadership in Energy and Environmental Design (LEED) green building rating systems.

For more information about the product
Please scan the QR code.



www.rockworth.com

The producer reserves the right to conduct construction changes and improvements of the products.
Colors presented in the catalogue may vary from the original colors of furniture